

BlueGreenTest® is a rapid test for detection of blue-green algae hepatotoxins in the water.

The test detects the following toxins: MC-LR, dm-MC-LR, MC-RR, dm-MC-RR, MC-LA, MC-LY, MC-LF, MC-YR, MC-WR, MC-LW, Nod-R.

The product has been developed together with VTT Technical Research Centre of Finland Ltd and the University of Turku and is sold under a license from the University of Turku for patent application WO2017109290.

The test package is made of environmentally friendly material and can be disposed of as energy waste or dropped off to a cardboard recycling point.

Package contents and other necessary equipment

The package contains accessories for one or three tests, depending on the package size. In addition, you will need a clean bucket or similar large container for the water to be tested. Keep the packing box for use in the test.

Each test kit consists of

- a test cassette (A)
- a sample jar (B)
- a pipette (C)
- disposable gloves (D)

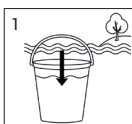
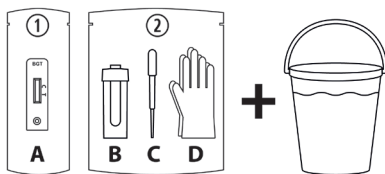

How to perform the test

1. Fill the container with the water to be tested.

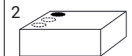

2. Place the closed test package box on a flat surface and open a perforated hole in the box for the sample jar.



3. Cover your hands with disposable gloves (D). Always use the gloves when handling the wet sample jar. Water may splash out of the jar when it heats up, so keep paper or hand towels at hand.

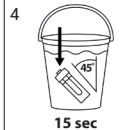

4. Immerse the sample jar (B) in the water container and keep it submerged in an inclined position for about 15 seconds. Take care that also the hole in the middle of the lid fills up with water.



5. Place the water-filled sample jar in the hole on the package box. A chemical reaction will heat up the sample jar, **so beware of the hot steam that forms!** Wait for at least 10 minutes.



6. Take the test cassette (A) and place it on a flat surface.

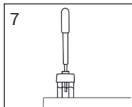

7. Using the pipette (C), draw up water from the middle hole of the sample jar (B).

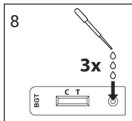

8. Drop three (3) drops into the smaller hole on the test cassette (A). Wait for 8 minutes, until 1 or 2 lines appear on the test cassette. The intensity of the lines varies depending on the amount of toxins detected.

WARNING

Safety instructions

- Hot water may splash out of the sample jar. The pH-value of the water is 12, so it may be corrosive if it comes into contact with bare skin.
- Cover your hands with disposable gloves throughout the testing.
- Keep out of the reach of children.
- A chemical reaction will heat up the sample jar. **Beware of the hot steam!**
- If water from the sample jar comes into direct contact with bare skin, immediately rinse it off with plenty of clean water.
- If water from the sample jar comes into direct contact with the eyes, immediately rinse the eyes with plenty of clean water and seek medical attention.
- Do not perform the test on a sensitive surface. Make sure to keep e.g. paper towels at your disposal for wiping up any splatters.

LEGAL DISCLAIMER

If you receive any symptoms when using the water, immediately stop using it even if the result of the test was negative. Even a small amount of toxins in the water can cause symptoms to people who are exposed to it, for example when the water is thrown on the heater in a sauna.

How to read the test result



One line at C

= No toxins in the water



One line at C and T

= The water contains toxins



No line at C

= The test is invalid